

MOTOR DATA	
MOTOR TYPE	1MR130
THEORETICAL DISPLACEMENT	13.0 cc/rev (0.79 cu in/rev)
TYPICAL RUNNING TORQUE AT PRESSURE P1	TO BE ADVISED
MAXIMUM CONTINUOUS PRESSURE P1	195 bar (2828 psi)
MAXIMUM SPEED AT PRESSURE P1	3500 rev/min
MINIMUM SPEED AT PRESSURE P1	300 rev/min
ROTATION WHEN VIEWED ON END OF DRIVESHAFT	CLOCKWISE
APPROX WEIGHT	kg (lb)
OPERATING TEMPERATURE RANGE	CONTINUOUS 0°C TO 80°C COLD START -20°C MAX INTERMITTENT 100°C
SHAFT SEAL TYPE	MEDIUM PRESSURE
MAX SHAFT SEAL / DRAIN LINE PRESSURE	CONTINUOUS 10 bar INTERMITTENT 17 bar

FOR OPERATING CONDITIONS OUTSIDE THOSE STATED PLEASE CONSULT
ULTRA HYDRAULICS LIMITED TECHNICAL SALES DEPARTMENT.

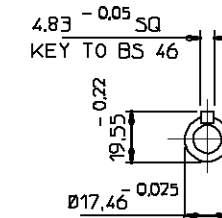
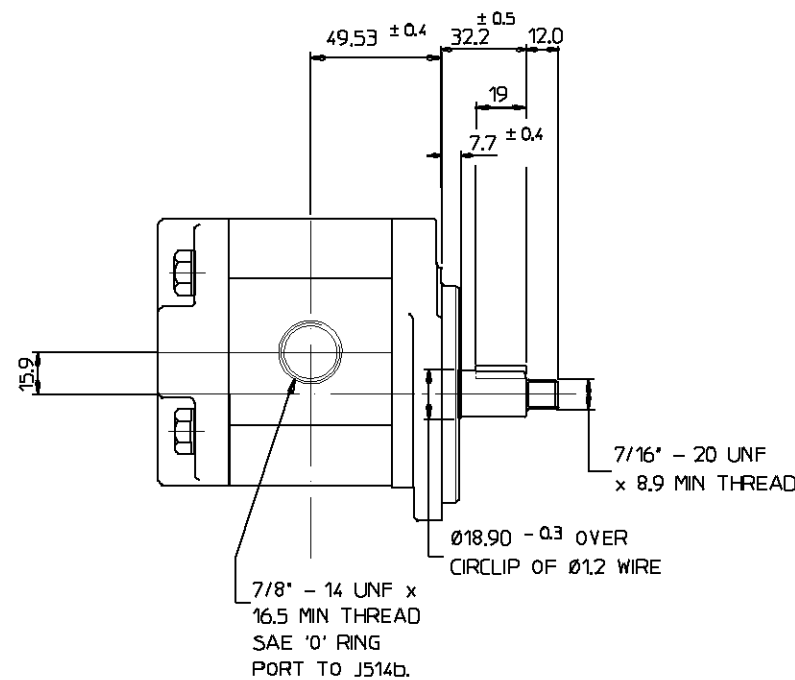

USED ON	PROJ	1	2	3	4	5	6	7	8	9	10	11	12	13	14	15	16	17	18
UNIT No.																			
ISSUE No.	1																		
ISSUED ON	AU20551																		
DRAWN	AM																		
DATE	23-Oct-00																		
CHECKED	AM																		
ENG APP.	AM																		
PRCO APP.																			

Part No.	6 1 8 4 M	THIRD ANGLE PROJECTION
TITLE	1MR130 J2B1B1-195-MA-CP1S1M-E2N1	
UNLESS OTHERWISE STATED	© ULTRA HYDRAULICS LTD 1999 THIS DRAWING IS THE PROPERTY OF ULTRA HYDRAULICS LIMITED AND IS CONFIDENTIAL. IT IS ISSUED SUBJECT TO THE CONDITIONS THAT:- (1) INFORMATION OR ANY PART CONTAINED IN IT SHALL NOT BE DISCLOSED IN ANY FORM TO A THIRD PARTY. (2) IT OR ANY PART OF IT SHALL NOT BE REPRODUCED IN ANY FORM. ALL DIMENSIONS IN MILLIMETRES / INCHES. GENERAL MANUFACTURING STANDARDS TO HDS 200 GEOMETRIC TOLERANCES and SYMBOLS TO BS 308.	
HYDRAULICS LTD. CHELTENHAM	SIZE A0	