

3-16-74



Installation Instructions

J17 Hydraulic PTO Kit

Operator's Manual 9-50581

J I Case
A Tenneco Company



INSTALLATION INSTRUCTIONS

J-17 HYDRAULIC PTO KIT

1. Place a clean pan under the tractor travel valve, remove the inlet hose from the valve and let the oil drain into the pan.

2. Remove the three screws from left side of rear seat support and install mounting bracket (ref. no. 5) using new screws.

3. Route valve inlet tube (ref. no. 9) from pump outlet hose to PTO valve inlet (upper) port so that it passes under the hydraulic motor and axle and up behind tractor, and loosely attach to pump outlet hose.

NOTE: Keep fittings, tubes and ports plugged as much as possible to prevent dirt entry.

4. Attach PTO valve inlet tube to elbow (ref. no. 3) and tighten fittings on both ends of tube.

5. Remove male elbow swivel fitting (ref. no. 14) that is loosely attached to straight male fitting (ref. no. 2) in PTO valve outlet (lower) port. Install it to the straight male fitting in the inlet port of the travel valve.

6. Route valve outlet tube between PTO valve outlet (lower) port and travel valve inlet so that tube passes under hydraulic motor and axle alongside the inlet tube.

7. Attach tube loosely at both ends first, then tighten fittings.

NOTE: Check all hydraulic fittings for tightness.

8. Install tube clamp (ref. no. 10) on tubes in area under orbit motor.

9. Refill reservoir being sure not to allow any dirt to enter.

10. Mount tiller and install hoses from two side ports on valve to two ports in tiller drive orbit motor. The front hose on the valve should go to the top port in the orbit motor and the rear one to the bottom to make the tiller rotate forward when the lever is pulled forward.

IMPORTANT: When tiller is removed, remove one hose at tiller orbit motor and the other at the valve. Then loop each hose and install it into its respective opposite port. This will keep dirt out of the system and provide added protection to the tractor hydraulic system.

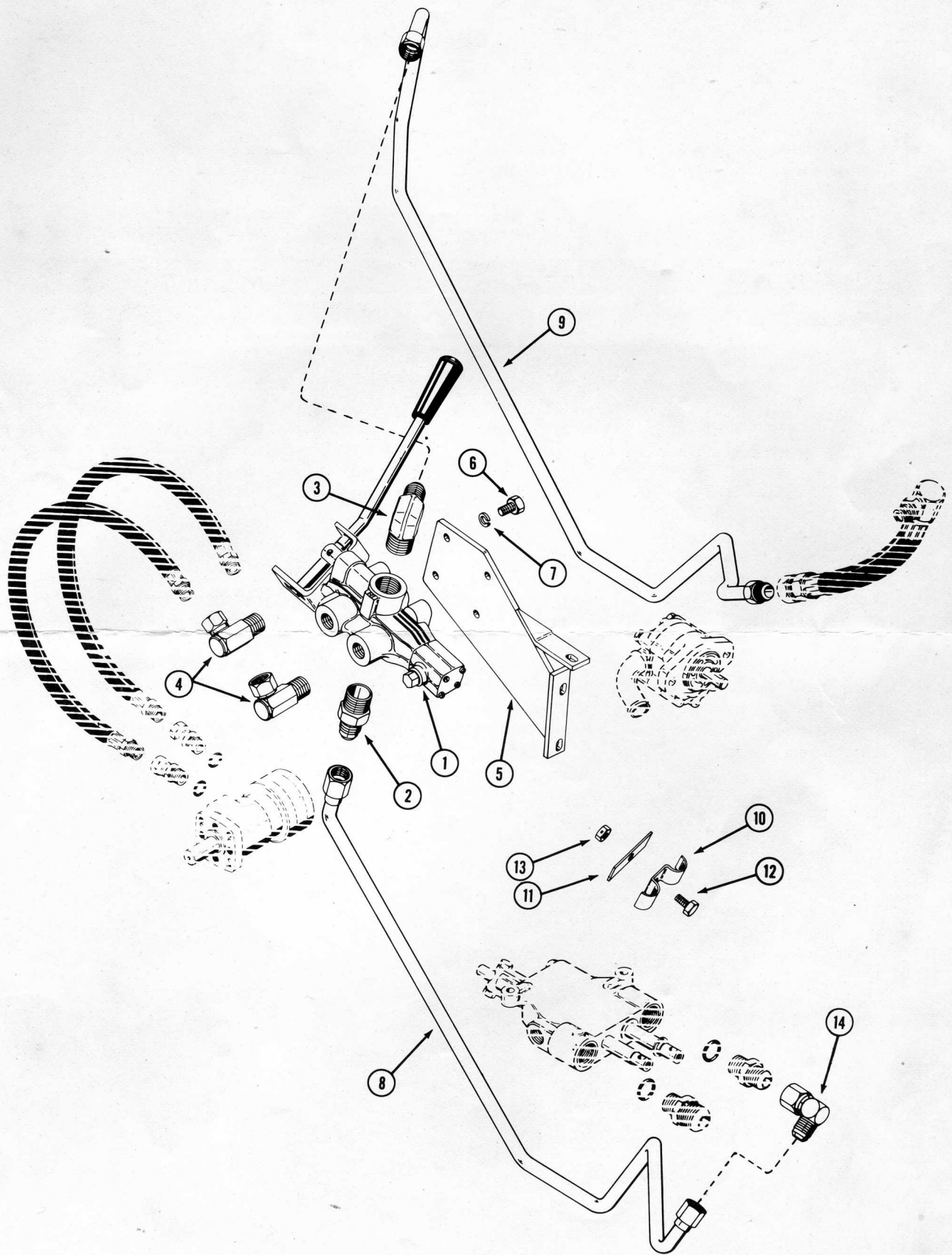

Printed In U.S.A.